

ABJB 125 Range

The ABB 125 provides a unique solution for the termination of offshore umbilical cables or onshore distribution systems. The power conductor compartment houses cable up to 15kV. A separate control compartment is used for terminating fibre optic or control cables.

- Work on optical fibres or control conductors without isolating HV supply
- Each compartment independently IP166
- Fault rated 50kA for 1.0 second
- DTS-01 deluge tested enclosure
- Range of paint and surface finishes

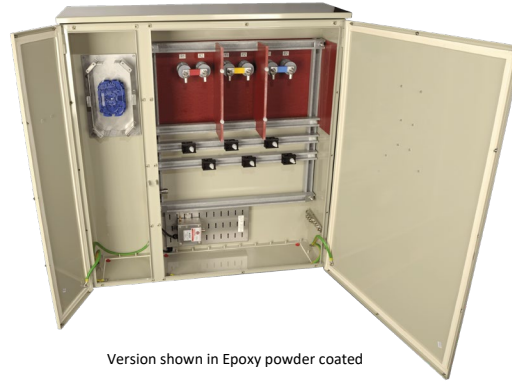

Version shown in Epoxy powder coated

15kV



Enclosure Ratings

Product Reference*	Control Location	Width (mm)	Height (mm)	Depth (mm)	Power Rating @ T4 (W)	Max Voltage (kV)	Max Current (A)	Max No. of Ways	Weight (kg)
ABJB1253(x-x)LH	Left	1200	1250	300	346	15	980	3	120
ABJB1254(x-x)LH	Left	1200	1250	300	346	15	980	4	120
ABJB1253(x-x)RH	Right	1200	1250	300	346	15	980	3	120
ABJB1254(x-x)RH	Right	1200	1250	300	346	15	980	4	120

* (x-x) demotes the number of connectors per phase, 1st position = top, 2nd position = bottom. For example: ABB1253(2-1)LH = 2 x conductors per phase top entry and 1 x conductor per phase bottom entry.

Standard Specifications

Enclosure Type	High Voltage
Ingress Protection	IP66/67 to EN60529, Type 4X, DTS-01
Material	2mm 316L Stainless Steel (EN 1.4404) enclosure with orbital finish, silicone gasket and captive 316 stainless steel fasteners, 3mm 316L (EN 1.4404) Stainless Steel gland plates
Ambient Temp Rating	-20°C to +40°C or up to -50°C to +55°C (refer to certificate)
Maximum Terminations	3 conductors per phase in & 3 conductors per phase out
Crimp Lugs	16mm ² to 1000mm ²
Earthing	Via studs on enclosure, door and gland plates
Mounting	Via 3mm thick external mounting straps, slotted upper strap for ease of installation
Certification	
Area Classification	Zone 1 & 21, Gas and Dust / Class 1 Division 2
Type of Protection	Ex sb (Apparatus Certified), Ex tb (Dust Protected), Ex op is (inherently safe optical radiation) or Ex op pr (protected optical radiation)
Apparatus Coding	Ex sb IIC 2 GD T4 Gb, Ex tb IIIC T70°C /T80°C Db Ex op is IIC T4 Gb, Ex op is IIIC T70°C /T80°C Db or Ex op pr IIC T4 Gb, Ex op pr IIIC T70°C /T80°C Db
Certificate Number	CML16ATEX7322X, IECEx CML 16.0099X

Dimensions

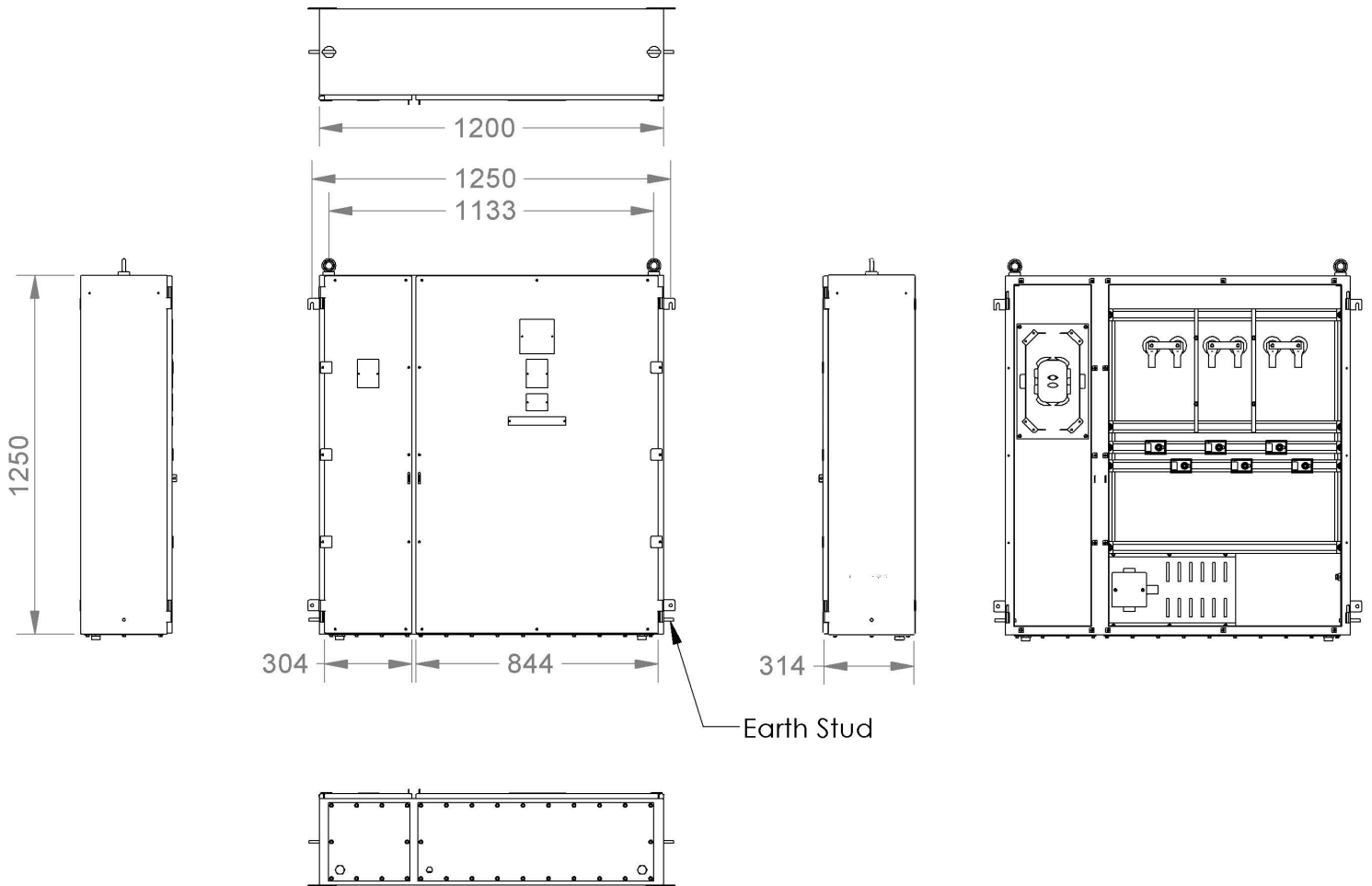

Options

ACH	Anti-condensation heater
EP	Electro-polished
PS	Epoxy powder coated, smooth finish (RAL colour may be specified)
PT	Epoxy powder coated, Hammer Grey
CP	Internal access protection cover plate
MB	Mounting boss provision for eye bolts

Add the required suffix to the product reference.

Example: ABJB1253(0-3)RHACH = ABJB 125, 3-way with 3 entries in bottom, right hand control compartment and anti-condensation heater.

Accessories

ABDM2010SS	M20 Breather drain
ABDM2510SS	M25 Breather drain
FBM12EEMS**	M12 Lifting Eye bolts in mild steel, <i>Note: Requires MB suffix option listed above</i>
FBM16EEMS**	M16 Lifting Eye bolts in mild steel, <i>Note: Requires MB suffix option listed above</i>

** Stainless steel lifting eye bolts also available, contact sales for information